

Health, Fast, Environmental Protection,
Low Cost!

PREFAB

HOUSE

Expandable Container

The expandable container house has the standard modular design and manufacture, it is environment protective.
It is widely used in Villa, office, hotel and dormitory.
It is easily assemble, disassembly and remove.
It can be expanded or closed according to your requirements.
Its life span is 20-30 years.
It can stand 8 grade earthquake.



SPECIFICATION	
Measure	6400*5950*2450mm
Packing size	6400*5950*2450mm
Wall panel	50/75mm EPS/rock wool/PU/glass wool sandwich panel with double-sided 0.4mm
Steel structure	2.5-3.0mm welding steel structure
Windows	Plastic steel/Aluminum alloy double-layer sliding glass window
Exterior door	Plastic steel/Aluminum alloy double-layer sliding glass door
Interior door	Plastic steel/wood/Titanium alloys door
Sub-floor	18mm MGO/Fiber cement board
Surface floor	Wood/PVC vinyl floor
Bathroom	Shower, seated toilet, wash basin
Kitchen	Sink with cupboard, stainless steel double sink, tap
Water pipe	PPR and PVC water supply and drainage pipe with fittings
Electricity system	Switch, socket, lamp light, waterproof socket, distribution box
Accessories	Paint, glass cement, floor nail, blind rivets etc.





Expandable Container

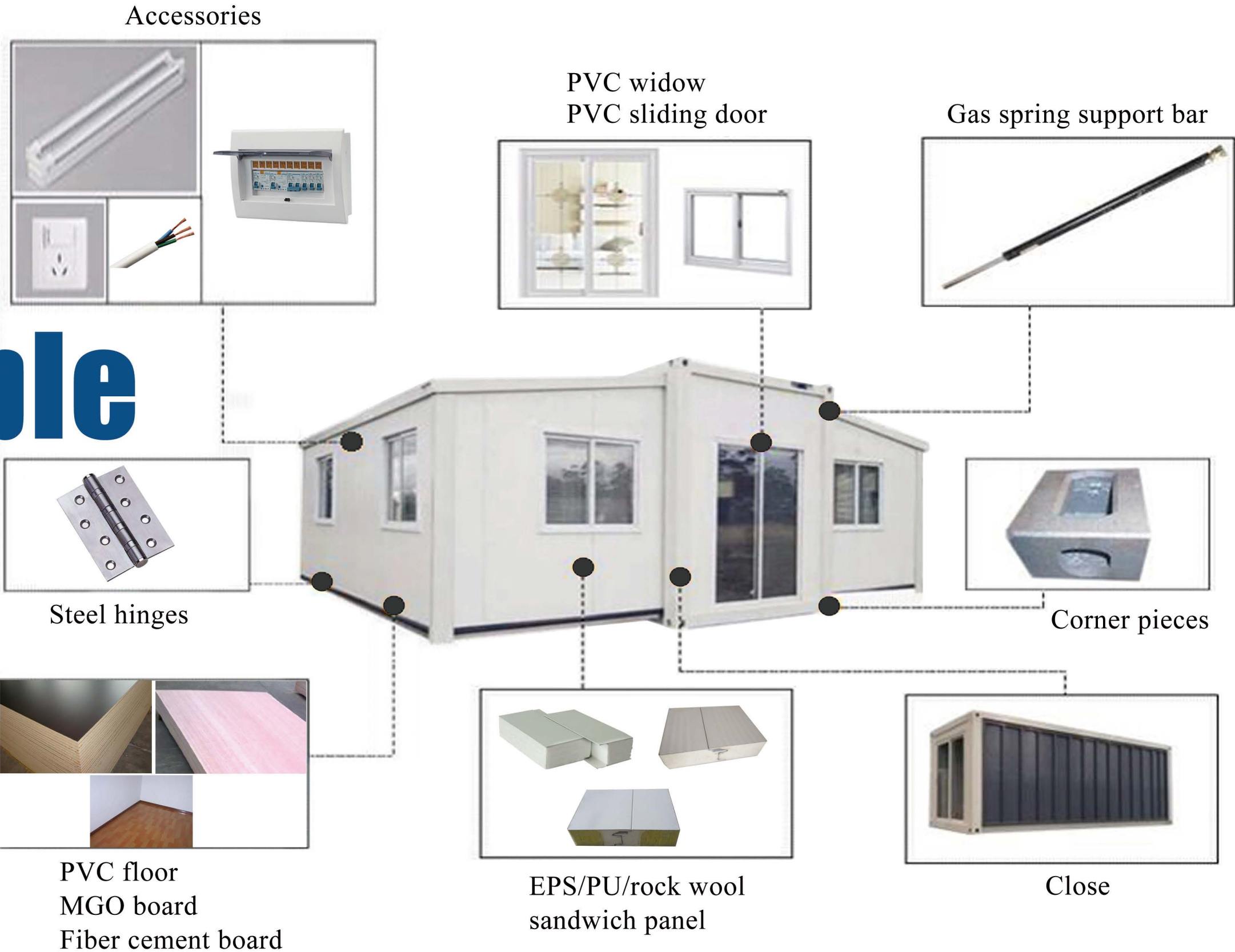

4 Steps 10 Mins Ready the house

Assemble progress

We will first finished prefabricated in factory, folded up the overall transport, save space, after shipping to the destination can be used, 5 person can finish operation.

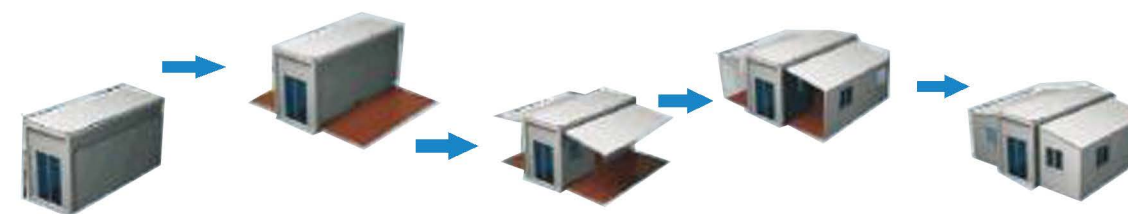

Structure

- ① 4mm折弯件 Thickness of 4mm Steel Bending 4 Pcs
- ② 2.5mm折弯件 Thickness of 2.5mm Steel Bending 16 Pcs
- ③ 80方通 Square Tube 80*40*2.0 42 Pcs
- ④ 60方通 Square Tube 60*30*1.8 8 Pcs
- ⑤ 80方通 Square Tube 80*80*2.0 4 Pcs
- ⑥ 150方通 Square Tube 150*75*3 4 Pcs

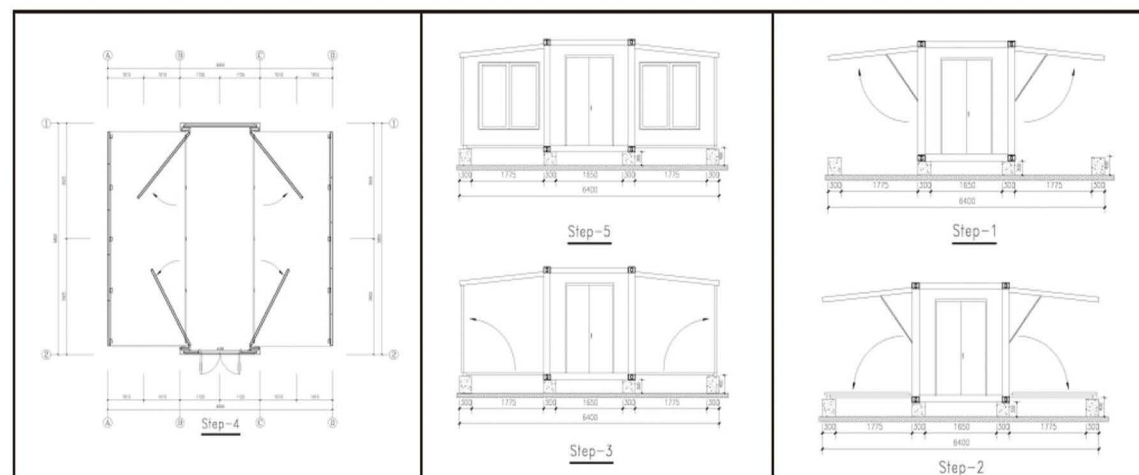
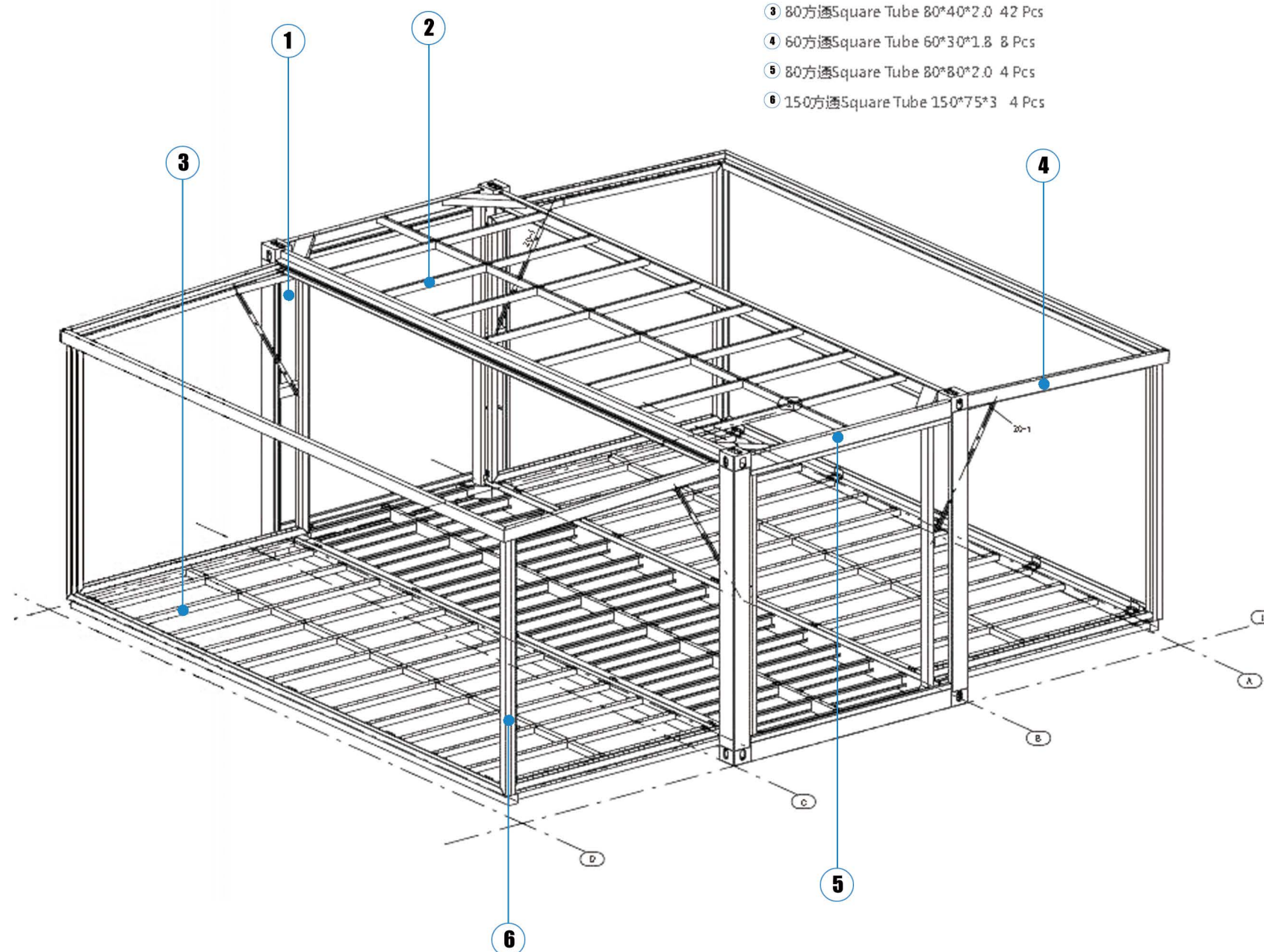



Total area :38.08m²

Manufacture Packing & loading

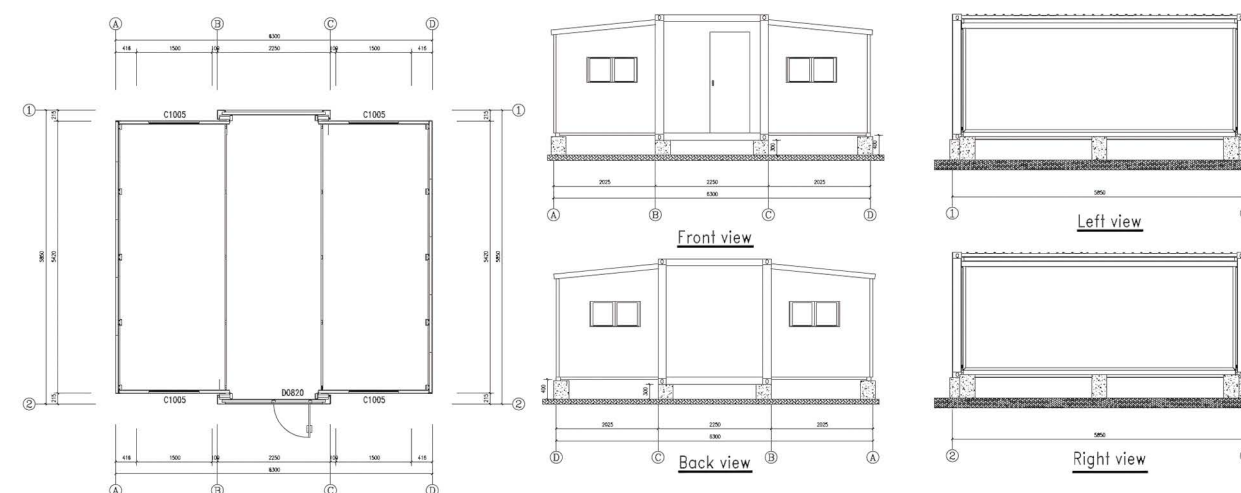

Packaging details: 2 sets
into a 40HQ open top
container

Delivery details: 15-20
days after getting
formal order



Container

1 bedroom 1 toilet design

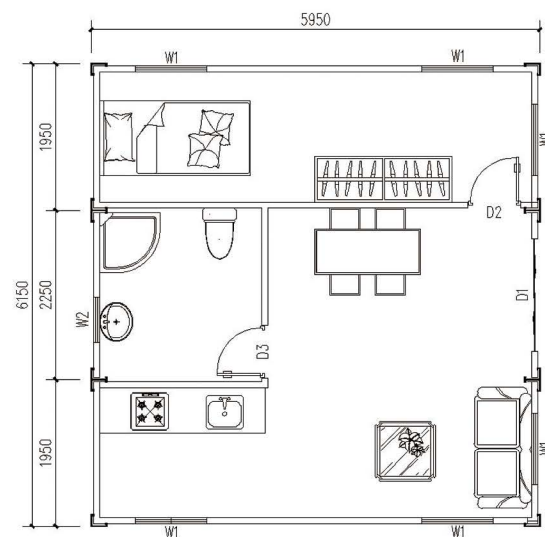



Container

2bedroom 1 toilet design



EXTERIOR PU DECORATIVE PLATE

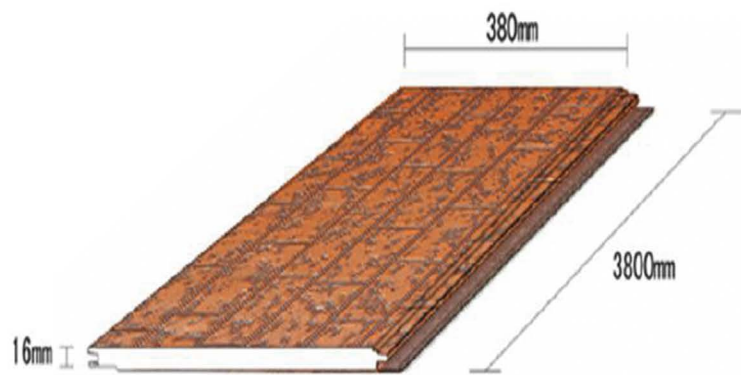

TESTING REPORT OF PHYSICAL PERFORMANCE

Testing Item	Technical requirement	Testing result	Testing method
Thermal conductivity (core material) W/(m·k)	≤0.025	0.025	GB/T 10295-1988
compressive strength, kPa	≥120	29	GB/T 8813-1988
water absorption, %	≤5	8	GB/T 8810-2005
density of the panel (three layers), kg/m ²	≥3.5	3.78	GB/T 6343-1995
bending resistance under 0.5KN, mm	≤18.3	13.3	GB/T 9341-2000
cementation strength, Mpa	≥0.10	0.238	JC/T 868-2000
smog resistance (h)	≥1000h	color is not changed and there is no spot of erosion	QB/T 3826-1999
weather resistance (h)	≥1000h	There is no damage on the surface and color changes from level 4-5	GB/T 16442.2-1999

EXTERIOR PVC DECORATION PLATE



Star bar



Closure



J-bar

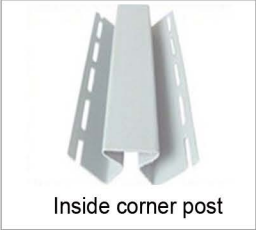

Inside corner post

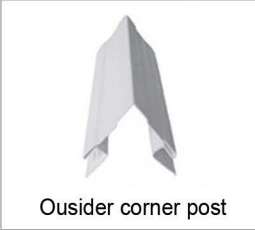

Outsider corner post



Link bar

WOOD STLE-PVDF PAINT



Q7S-001



07S-001



457S-001



W7S-001

FINE BRICK STYLE



M1-001



L1-001



G1-001



C1-001

COARSE BRICK STYLE



L2-001



D2-001



U2-001

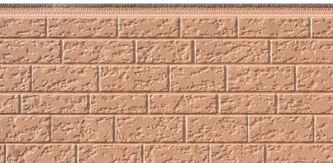

R2-001



CONTAINER HOUSE SERIES



PDX01



XDD01



XDD02



SGD01



KG01



KG02



KG03



KG04



CZ01



CZ02



CZ03



CZ04



CZ05



DX01

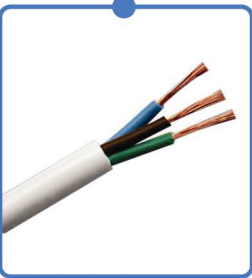

DX02



SMT
斯姆特螺丝
高品质紧固件



Nail

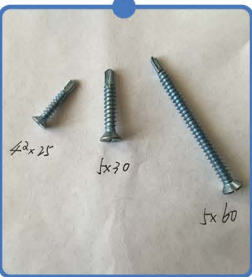

Nail



Nail



Bolt



Bolt



Bolt



Bolt

BATHROOM/KITCHEN SERIES



YF01



YF02



YF03



YF04



DB01



ZB01



ZB02



LP01



GD01



CG01



CG02



LP02



CG03

NAILS/BOLTS SERIES